

# 1

Realizar un agujero M8, insertar el taco y roscar el anclaje de madera a la pared.

Make an M8 hole, insert the wall plug and thread the wooden anchor to the wall.

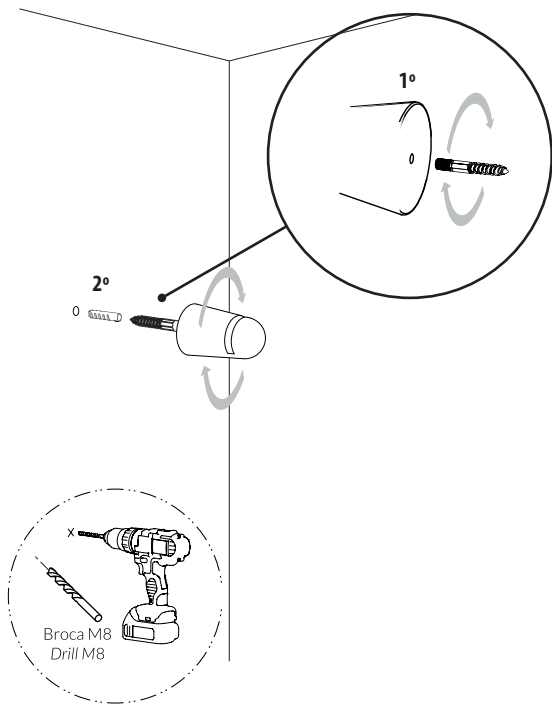

# 3

Colocar la pila de 1,5 V en el mecanismo y tapar.

Place the 1.5 V battery in the mechanism and cover.

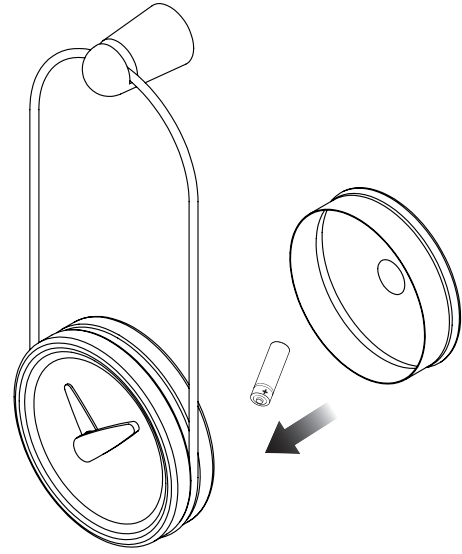

# 2

Elegir el lado que queremos y montar las agujas.

Choose the wanted front side and assemble the clock hands.

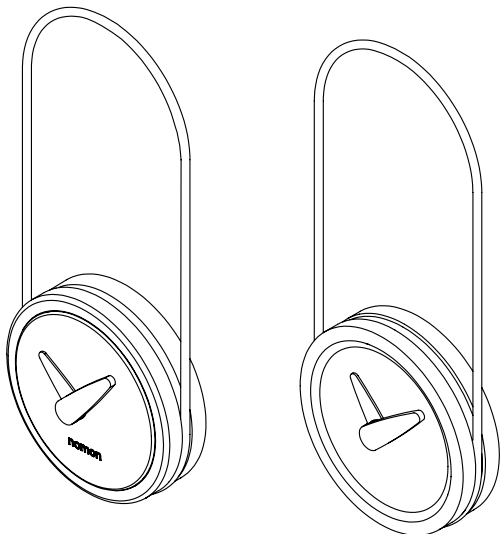

FRONTAL EN LATÓN PULIDO  
FRONT PART IN POLISHED BRASS

FRONTAL EN MADERA DE NOGAL  
FRONT PART IN SOLID WALNUT WOOD

# 4

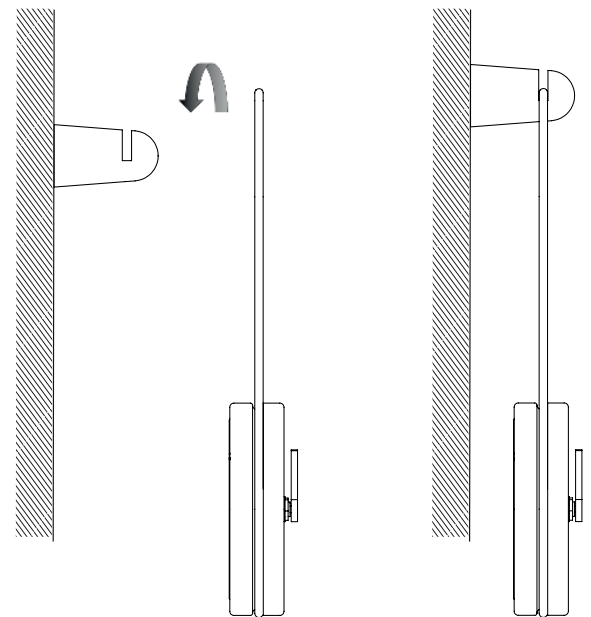

5

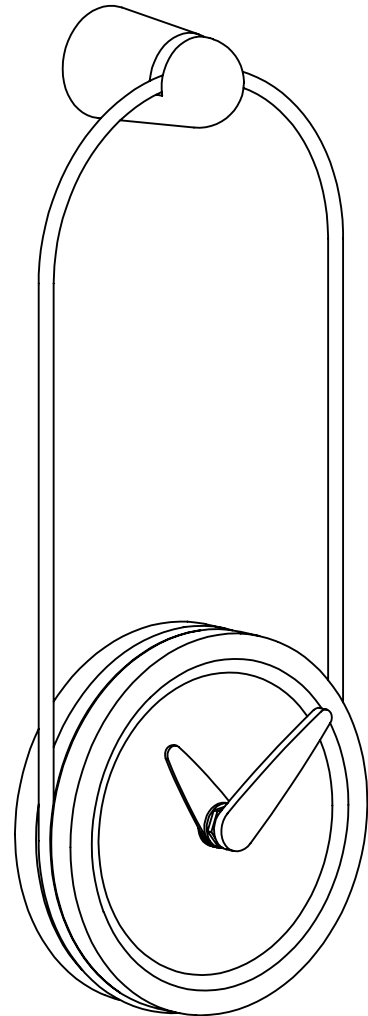
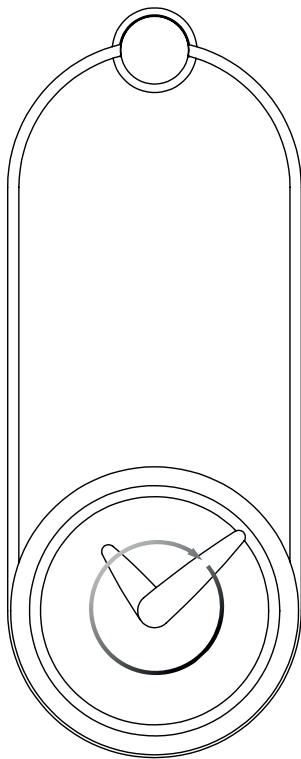

Gire cuidadosamente la aguja minuterá en el sentido de las agujas del reloj hasta alcanzar la 12, continúe girando la aguja minuterá hasta alcanzar la hora deseada.

**ATENCIÓN:** Nunca girar en sentido contrario a las agujas del reloj.

With your index finger, wind the minute (long) hand clockwise until both hands are at 12 o'clock. Then, to set the time, continue to wind the minute hand clockwise until the desired time is reached. NEVER wind the minute hand in the anti-clockwise direction.